

SANTINT

Perfitall

Paint Mixing Machine

High-end

Flexible

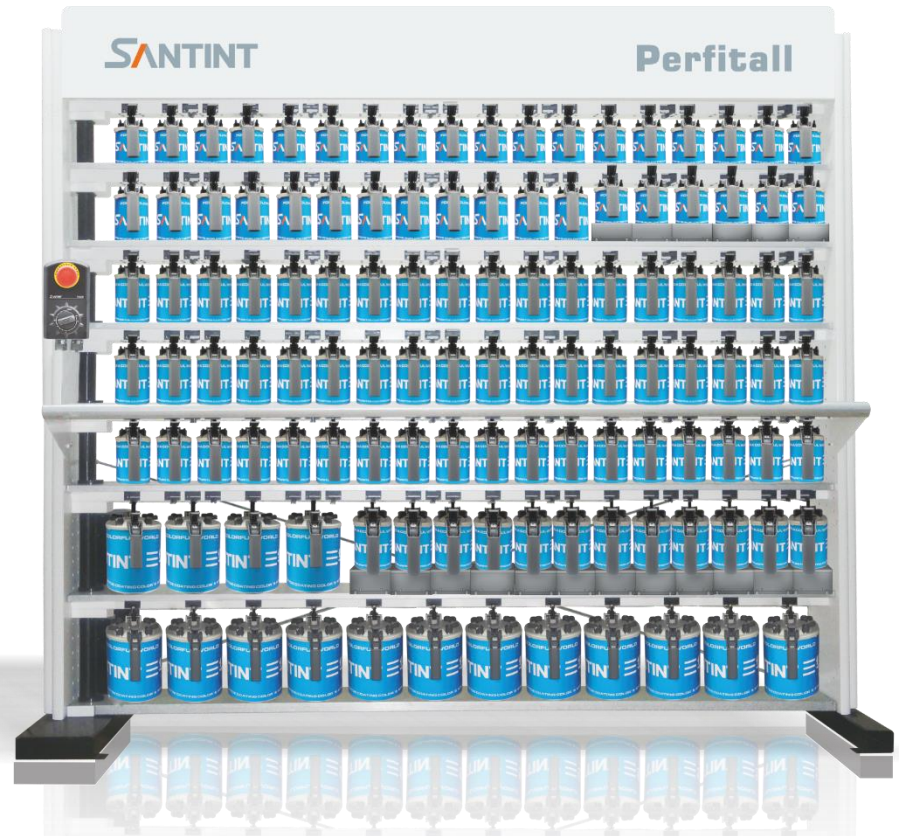

Series	Size	20" Container	Cans Configuration					
PA4	1000×630×2077 mm	44 Pieces	4 0	3 1	2 3	1 4	0 6	—
PA6	1360×630×2077 mm	32 Pieces	6 + 0	5 + 1	4 + 3	3 + 4	2 + 6	1 + 7
			0 + 9	—	—	—	—	—
PA8	1720×630×2077 mm	32 Pieces	8 0	7 1	6 3	5 4	4 6	3 7
			2 9	1 10	0 12	—	—	—
PA10	2080×630×2077 mm	26 Pieces	10 + 0	9 + 1	8 + 3	7 + 4	6 + 6	5 + 7
			4 + 9	3 + 10	2 + 12	1 + 13	0 + 15	—
PA12	2440×630×2077 mm	26 Pieces	12 0	11 1	10 3	9 4	8 6	7 7
			6 9	5 10	4 12	3 13	2 15	1 16
			0 18	—	—	—	—	—

■ Mixing Time : 15 mins ■ Mixing Speed : 72rpm =2.5-5L tinter =0.5-1L tinter ■ Power : 400W/550W/750W (optional)

■ Options: explosion-proof motor / side hanging plate / working table / tinter shelf / back-storage shelf

Flexible choice of Layer height and width. Flexible configuration of big and small cans at same layer.

Innovative design makes 2 big cans=3 small cans. The positions of cans are flexible for your changing needs.



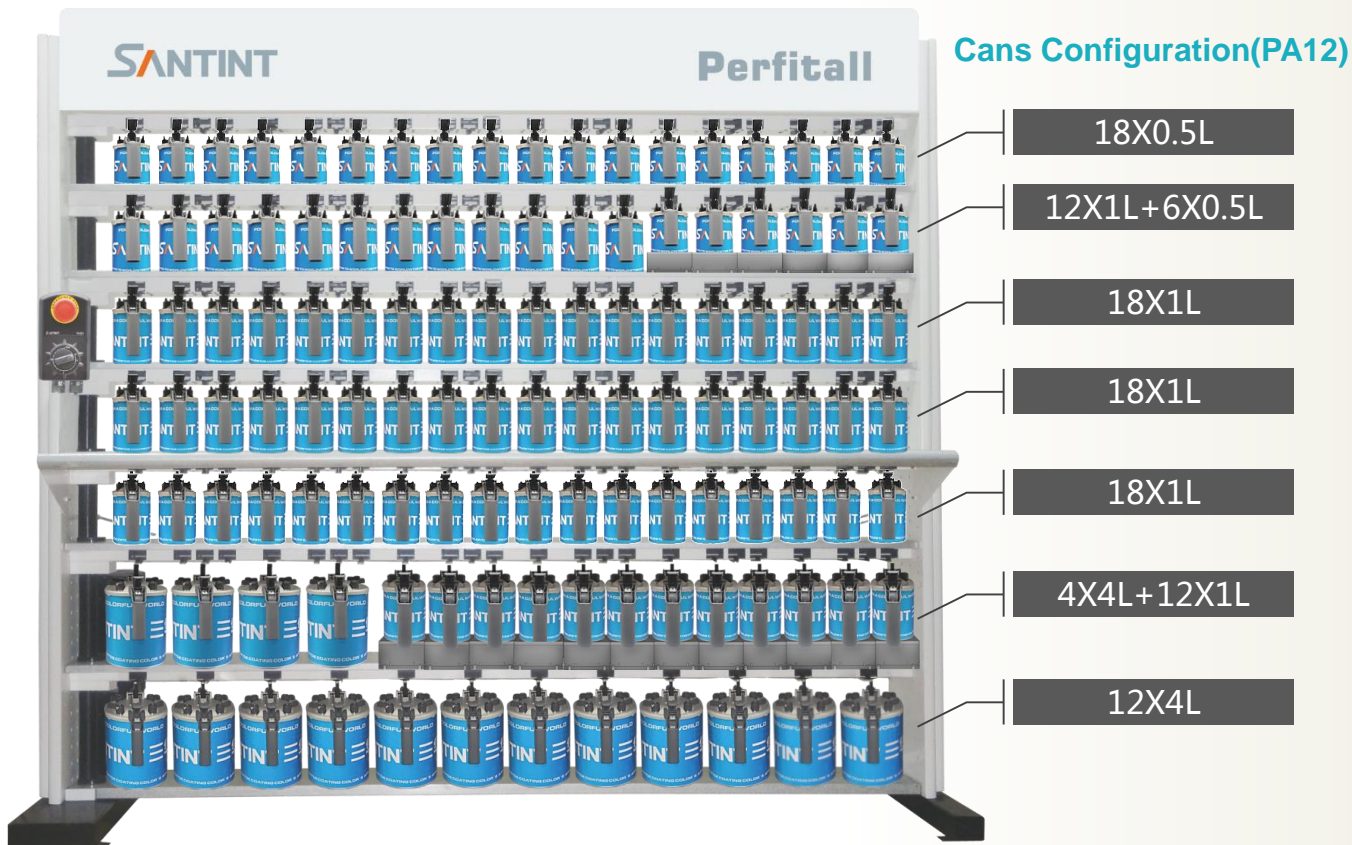

7 < 6 !

Lower height, more layers,
larger capacity.

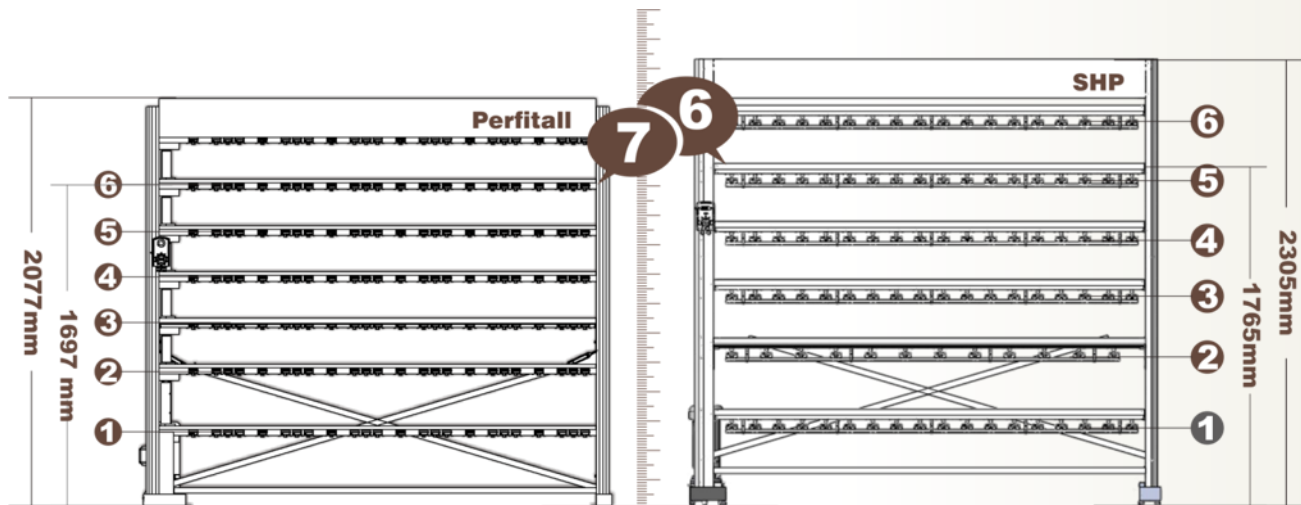

■ Riser Configuration

Perfitall Riser Configuration (Riser Height 2014mm)									
Layers Size	6			7				8	
0.5L	5	4	3	7	6	5	4	1	1
1L								7	6
2.5L	1	2	3	—	1	2	3	—	1
3.5-4L									—
5L									—

■ Simple Installation Steps

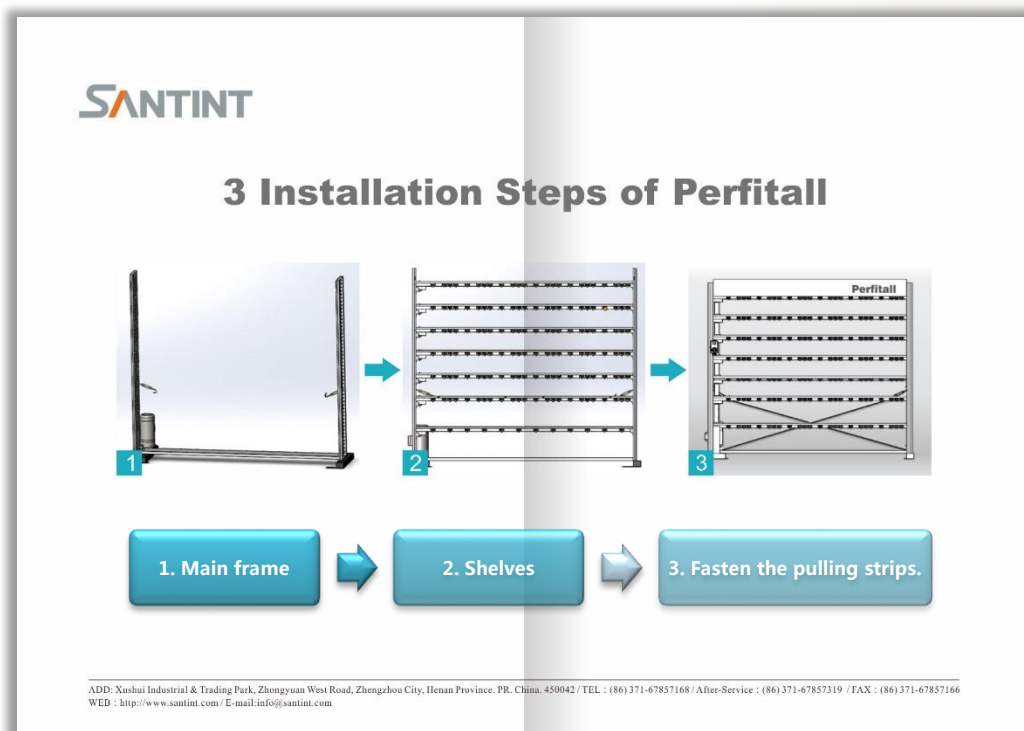

Innovative shelf installation

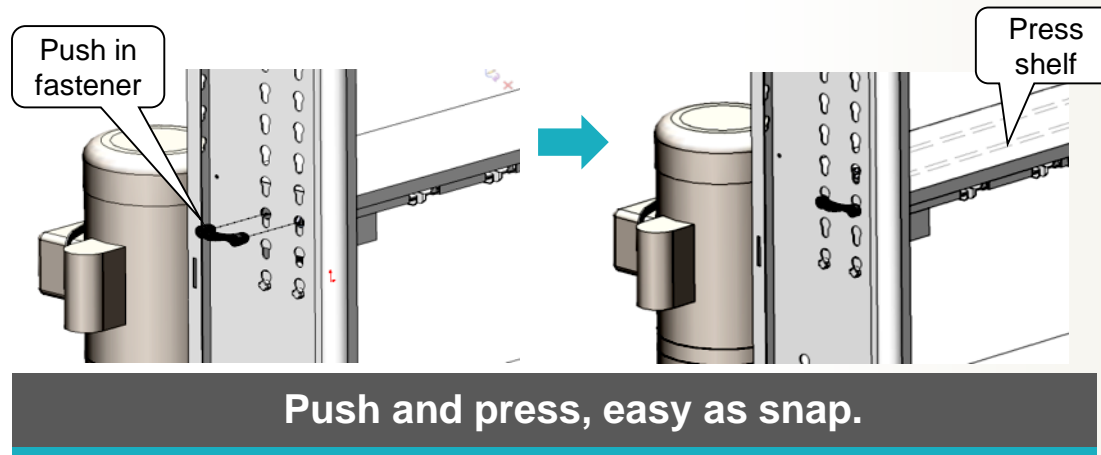

■ One person, three steps, half an hour.

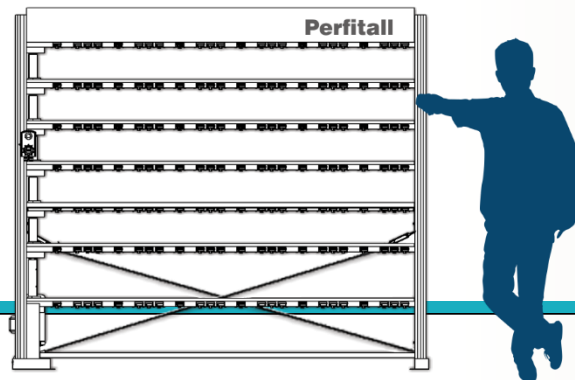

■ Overall package



Pallet + carton + plastic package design is convenient for storage and safe for transportation.



■ Ready for Change

Perfitall could be equipped with heating module without any modification.

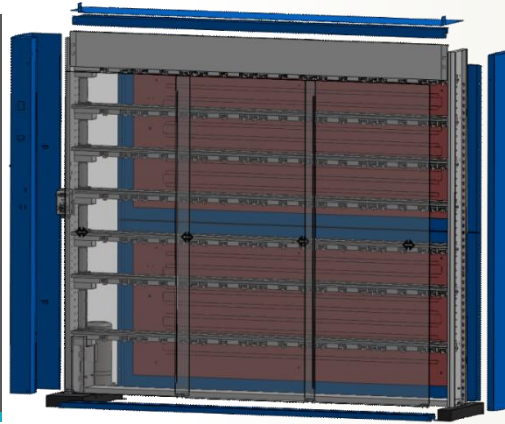

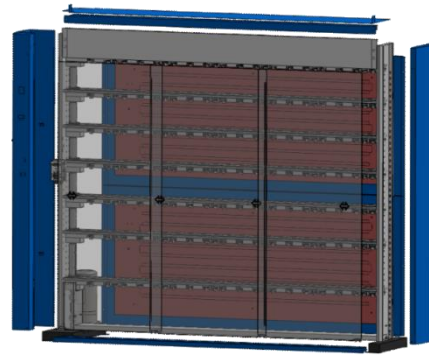
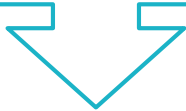
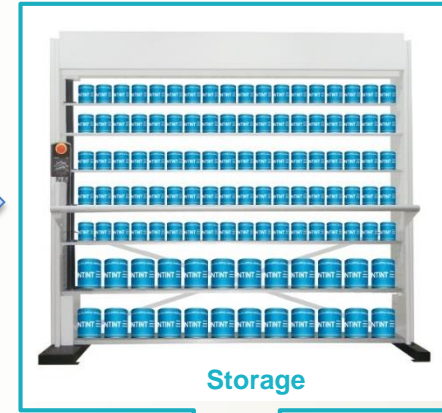
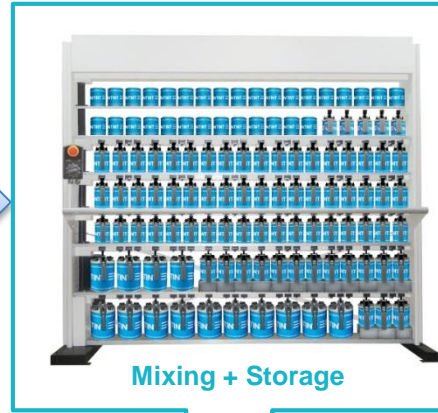

Thermal + Mixing + Storage

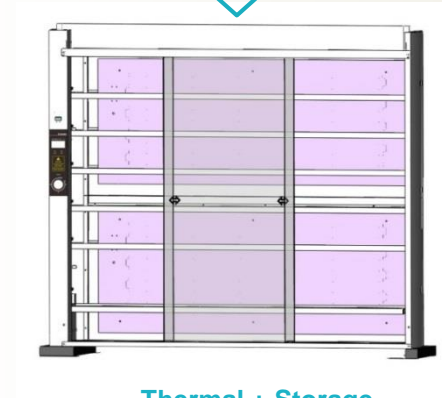

Thermal + Storage

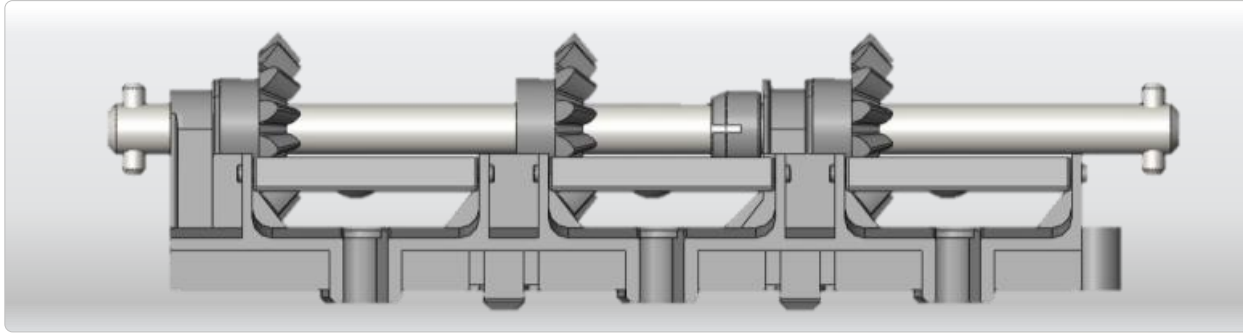

■ Gear-driven Module

Reliable performance.

Calibration-free, low noise.

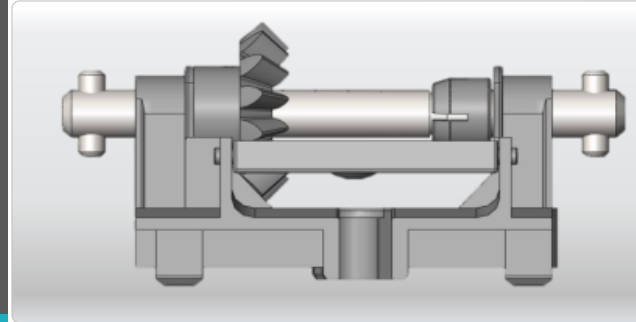

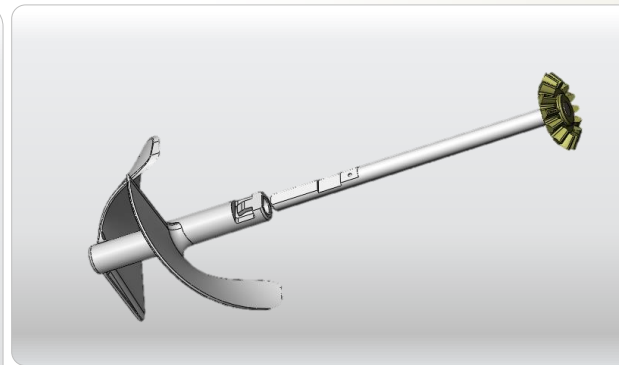
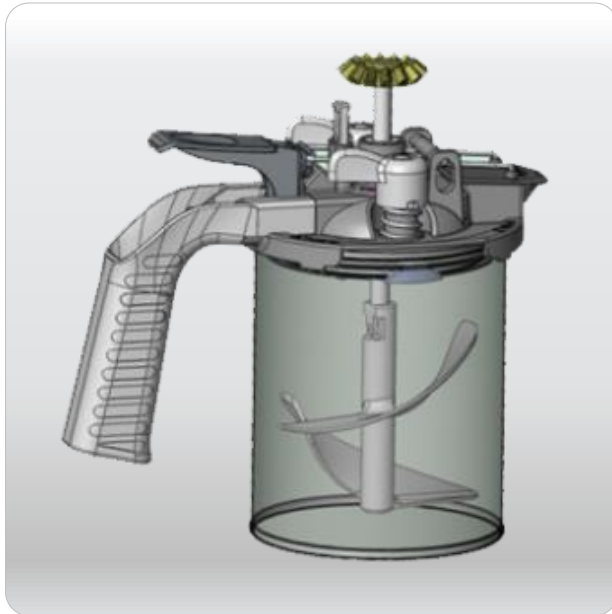

Simple and smart structure,
easy to install, self-adaptive to paint
can height.

■ Started layer by layer

Avoid over-loading, motor protection.

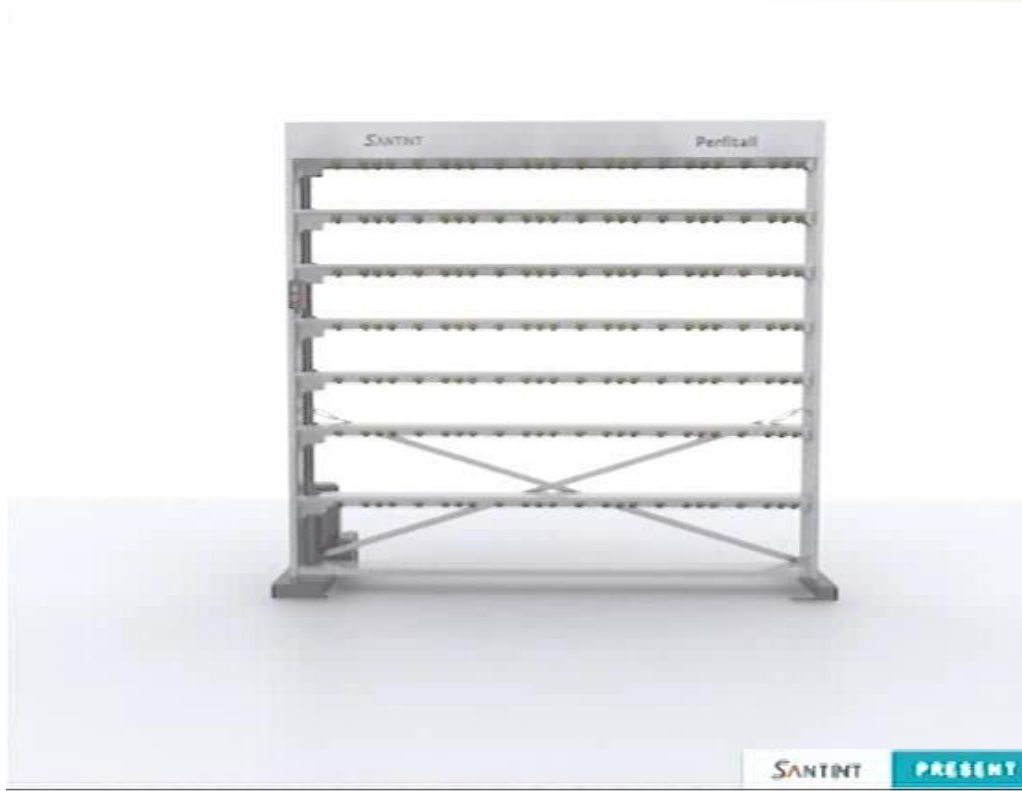

[Click to play](#)

■ Explosion-proof Motor & Switch Box

■ Explosion-proof design.

Atex, IECEx, and UL certified. In line with the safety standards in Europe and America.

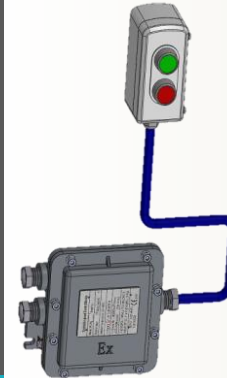

■ Storage Shelf and Mica Shelf

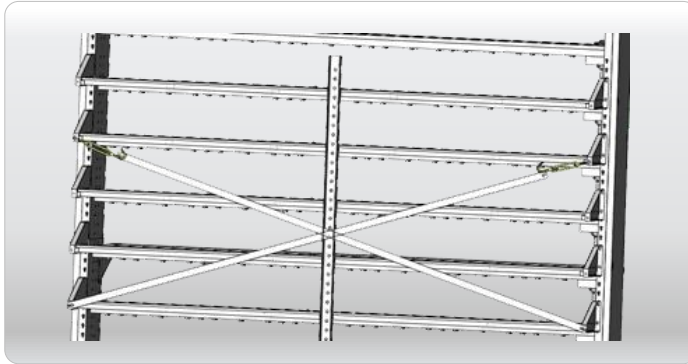

Installation holes reserved on risers for installing and adjusting back storage shelf at any time.

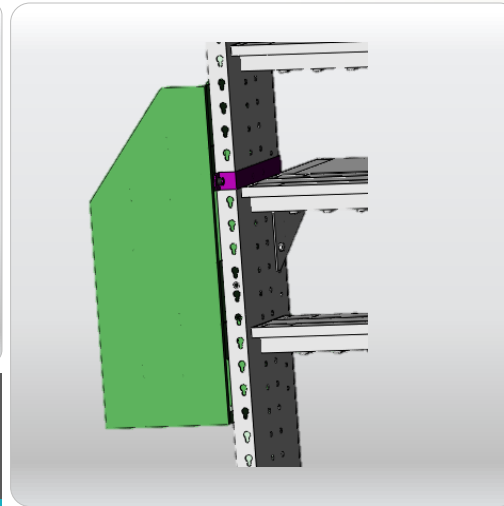

No need to change existing structure. Suitable for module with/without hanging plate after adjustment.

The logo for SANTINT, featuring the word "SANTINT" in white uppercase letters on a teal background. The letter "A" is stylized with a diagonal orange and white stroke.The logo for Perfitall, featuring the word "Perfitall" in white uppercase letters on a dark grey background.

SANTINT · CHINA

Address: Xushui Industrial Trade
Park, Zhengzhou.
Tel: +86 371 6785 7168

SANTINT · POLAND

Address: ul. Postepu 19. mag.5
02-676 Warszawa Polska
Email: info@santint.com

SANTINT · U.S.A

Address: 2000 Bloomingdale Road, Suite
220, Glendale Heights, IL 60139
Tel: +1 847 350 6911

SANTINT · AUSTRALIA

Address: 2/4 Weddel Court
Laverton North Victoria
Email: info@santint.com